



PARK POINT MARINA INN

Meetings & Conferences

VENUES & FLOOR PLANS

Our Lake Superior Conference Center can be divided into two separate rooms; the Harbor View Room and the Boat Club Room. Both offer incredible views of the Duluth Harbor. The Lake Superior Conference Center can accommodate up to 80 people.

We provide options for various room set ups and have the most modern equipment available to enhance your meetings and presentations. The connecting outdoor balcony can be used for breakout sessions, beverage service or a relaxing area to view passing ships. We also have two other outdoor patios that are used for break out sessions or separate group meetings. Our facility is one of the reasons why we are Duluth's #1 meeting venue.

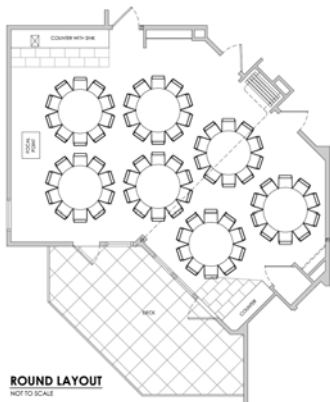

Lake Superior Conference Room

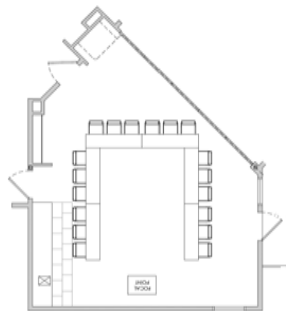

Boat Club Room



Harbor View Room

ROOM NAME	DIMENSIONS (L x W)	AREA (SQ.FT)	BANQUET ROUNDS	THEATRE	BOARD	CLASS	U SHAPE	LARGE U
Lake Superior	22 x 39	860	70	73	24	51	24	30
Harbor View	22 x 24	560	40	46	18	21	16	0
Boat Club	22 x 15	300	16	25	12	12	0	0
Outdoor Balcony	26 x 12	312	8	0	0	0	0	0